

# Signature Information

## Features and Benefits

Made in USA - same factory as Vanity Flair

Each piece is built one at a time, and signed by the craftsman

8 Designs, each available in 9 sizes, 24" - 72"

*11-12 sizes*

14 Finishes available

Cases made with 3/4" Formaldehyde Free Furniture Grade Plywood



Inset Doors and Drawers

Drawers and Interiors are finished to match exterior

True mortise and tennon door/drawer front construction

Full Extension, Soft Close Drawer Runners

Drawer runners are mounted to 3/4" interior walls

120 degree, Soft Closing Doors

3/4" Mortise and Tennon Doors with 5/8" solid wood panel

Parker and Taylor have 3 base options



Custom Sizing Available

## Available Finishes

### Stains

- S1 Normandy
- S2 Briar
- S3 Brandy
- S4 Black Forest
- S5 Coffee Bean
- S6 Piedmont

### Paints

- S11 Blanc
- S12 Nonchalant
- S13 China Red
- S14 Robin Egg
- S15 Super White
- S16 Harbor Gray
- S17 Silverstream
- S18 Sable

*New Paints from last year*

## Limited Lifetime Warranty

The Furniture Guild warrants its products to be free from defects in materials and workmanship under normal home use and service for as long as the original customer owns the product. Our obligation under this warranty shall be limited to the repair or exchange of any part or parts which may prove defective under normal home use and service during this period. Replacement of drawer slides and/or hardware are subject to the availability from our suppliers. This limited warranty does not cover defects caused by improper storage, installation, misuse or neglect. Nor does it cover any expense involved in removing, shipping and reinstalling any items or products. This warranty applies only to the original consumer purchaser of these products and at the original site of installation only. Furniture Guild reserves the option of approving field repair or returning the cabinet or component to the factory for correction.

We exclude and are not responsible for any consequential damages nor for any incidental damages arising out of the breach of any expressed, written, or implied warranty which relates to our products. Some states do not allow the exclusion or limitation of incidental or consequential damages so the above limitation or exclusion may not apply to you.

We will not assume, nor authorize any person to assume for us any liability in connection with the sale of Furniture Guild's products. This warranty is in lieu of all other warranties expressed or implied. To file a warranty claim, the purchaser should contact the local authorized Furniture Guild dealer who will assist in servicing the claim.

Show the floor display loaded + let the consumer decide what they don't want

## Accessories

### Pullout Tray

A full extension tray behind doors which allows easy access to items inside the cabinet.

ITEM #	W	D	H		
PTRAY	custom	16 3/4	6		\$ 350.00

*Must*

### Adjustable Shelf

Available most anywhere. We use metal grommets to give shelf holes a finished look

ITEM #	W	D	H		
ADSF	Custom	Custom	Custom		\$ 150.00

### Side Shelves

Interior side shelves for sink cabinet interiors. Provides 4-6" storage on either side of plumbing

ITEM #	W	D	H		
SSHELF	Custom	Custom	Custom		\$ 195.00

### Drawer Divider

"H" style drawer divider slide front to back to provide adjustable divided storage inside a drawer

ITEM #	W	D	H		
DDL12	<12	8	2		\$ 100.00

*good option*

**Hairdryer / Curling Iron Kit** \*Power Option Recommended when ordering this item

Decorative wooden bracket with heat resistant inserts mounted to the back of a door. (spec left or right)

ITEM #	W	D	H		
HDCI	Custom	Custom	Custom		\$ 195.00

*must*

### Power Option

A powered receptacle inside the cabinet which allows you to leave your appliance plugged in and hidden.

ITEM #					
PWR110					\$ 195.00

*must*

### Laundry Hamper

A forward tilting door on a bank or wing that houses our convenient system for holding laundry.

Disguised as a door or stack of drawers. (Requires Wing or Bank Cabinet)

Fits on all linen towers.

ITEM #	W	D	H		
LH10	10	12	20		\$ 250.00
LH16	15	12	26		\$ 250.00
LH22	21	12	26		\$ 250.00
LH28	27	12	26		\$ 250.00

### Trash Pullout

Usually disguised as a door or stack of drawers, We integrate 1 or 2 standard 11 x 14 trash cans into a full extension, soft closing pullout. (Requires Wing or Bank Cabinet)

Fits on all linen towers.

ITEM #	W	D	H		
TR1	15	Includes 1 can			\$ 250.00

### Under Sink Light

Surface Mounted LED light bar is activated automatically when the door opens.

Requires a power receptacle

ITEM #	W	D	H		
INTLT23DR	0.5	1/2	23"		\$ 375.00

*must*

*LED glows the inside of the cabinet*

### Drawer Light

Battery operated surface mounted LED light. Attaches to any drawer and provides light when drawer is opened. Motion activated. 3 AAA batteries included. Requires installation.

ITEM #	W	D	H		
DWRLT1	7	1	1		\$ 80.00

*must*

*Battery operated LED Motion activated*



# Stone Countertops

## Features:

Colors Available: Black Granite, White Carrara Marble, Beige, or Emperador Marble

Available in five sizes - 25", 31", 37", 49", and 61" (61" is double sink only)

Top pre-cut for wide spread faucet and 18" vitreous china undermount sink

Square eased edge on 3 sides

All tops are 1" thick except Black Granite (3/4")

Backsplash Included

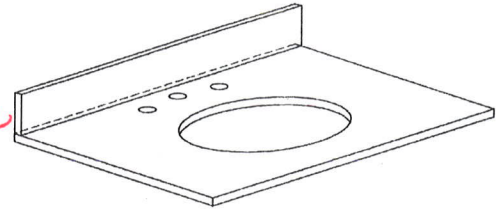

*Top is cut of our Sink only.*

*No 43" Top*

## Color Codes:

BL Black Granite

BG Beige

WT White Carrara Marble

EM Emperador Marble

When ordering add color code to item # for top.

ex. TOP3722BL = 37" top in Black Granite

## To Fit Oval Sink

Item #	Size	COLOR CODE-			
		WT Carrera 1" Thick	BL Black 3/4" Thick	BG Beige 1" Thick	EM Emperador 1" Thick
TOP2522	25" x 22"	\$560	\$560	\$560	\$560
TOP3122	31" x 22"	\$630	\$630	\$630	\$630
TOP3722	37" x 22"	\$750	\$750	\$750	\$750
TOP4922	49" x 22"	\$980	\$980	\$980	\$980
TOP6122 (Double Sink)	61" x 22"	\$1,560	\$1,560	\$1,560	\$1,560
TOPSS	sidesplash	\$50	\$50	\$50	\$50

*Tops are the same Price*

## Recommended Sinks

SINKOV1518W	White Undermount Oval	\$85
SINKOV1518L	Linen Undermount Oval	\$85

*No Rectangular Sinks*

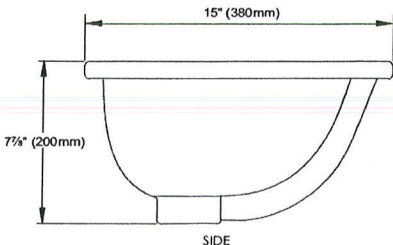
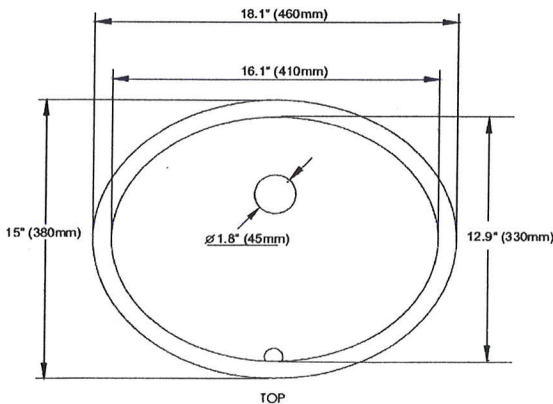

*New at 2012*

*Priced with Sink Now*

**280 Stephen Vanity Configurations**

20" and 24" versions are single door hinges right

ITEM #	W	D	H	A	Stone Top/Sink
280-0120	20	21.5	34	1995	N/A
280-0124	24	21.5	34	1995	645
280-0230	30	21.5	34	2095	715
280-0236	36	21.5	34	2195	835

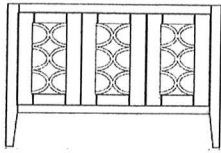

*great floor display*

ITEM #	W	D	H	A	Stone Top/Sink
280-0336	36	21.5	34	3195	835
280-0436	36	21.5	34	3195	835

280-0336 has pullout on left  
280-0436 has pullout on right

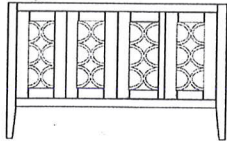

ITEM #	W	D	H	A	Stone Top/Sink
280-0542	42	21.5	34	3695	N/A
280-0548	48	21.5	34	3795	1065
280-0560	60	21.5	34	3895	N/A

Pullouts on both sides

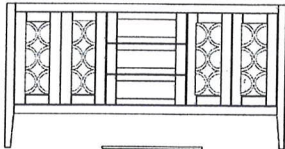

ITEM #	W	D	H	A	Stone Top/Sink
280-0760	60	21.5	34	3995	1730
280-0766	66	21.5	34	4095	N/A
280-0772	72	21.5	34	4195	N/A

3 drawers in the middle

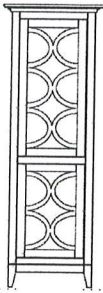

**Stephen Linen Tower**

\*Measurements are without crown molding

Includes 3 adjustable shelves in upper section

Includes 2 adjustable shelves in lower section

Hinge Left or Hinge Right

Hamper Option - \$250.00

ITEM #	W	D	H	A
280-0924L	*22	*15	78	3395
280-0924R	*22	*15	78	3395

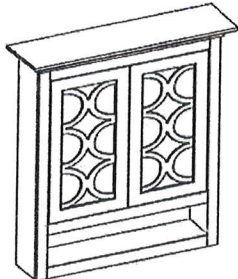

**Stephen OTJ Cabinet**

\*Measurements are without crown molding

Includes 2 adjustable wood shelves

*New in all styles*

ITEM #	W	D	H	A
280-2724	*24	*8.5	32	1495
280-2730	*30	*8.5	32	1595

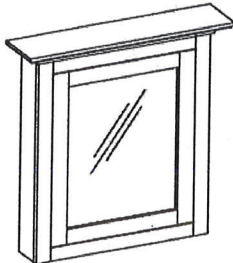

**Signature Medicine Cabinets**

\*Measurements are without crown molding

Mirrored Back panel in cabinet

Mirrored Door Front

*New in all styles*

Includes 3 adjustable glass shelves

Hinge Left or Hinge Right

Surface Mount	W	D	H	A
200-2516 L/R	*16	*4.75	32	1195
200-2520 L/R	*20	*4.75	32	1295
200-2524 L/R	*24	*4.75	32	1395

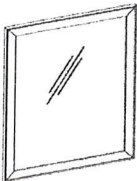

Recessed	W	D	H	A
200-2616 L/R	*16	*4.75	32	1195
200-2620 L/R	*20	*4.75	32	1295
200-2624 L/R	*24	*4.75	32	1395

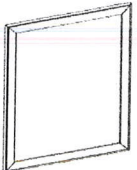

**Face Frame Mirror**

ITEM #	W	D	H	A
200-2016	18.5	.75	33.25	525
200-2020	22.5	.75	33.25	535
200-2024	26.5	.75	33.25	545

**Face Frame Medicine Cabinet Surround**

ITEM #	W	D	H	Robern Size	A
200-2116	18.5	.75	33.25	16 x 30	475
200-2120	22.5	.75	33.25	20 x 30	489
200-2124	26.5	.75	33.25	24 x 30	495



Wall hung available in all styles + all sizes

**180 Wall Hung Stephen Vanity Configurations**

20" and 24" versions are single door hinges right

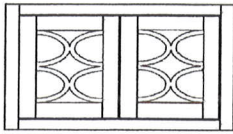

ITEM #	W	D	H	A	Stone Top/Sink
180-0120	20	21.5	34	1945	N/A
180-0124	24	21.5	34	1945	645
180-0230	30	21.5	34	2045	715
180-0236	36	21.5	34	2145	835

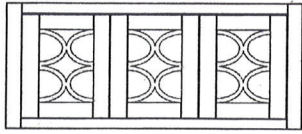

ITEM #	W	D	H	A	Stone Top/Sink
180-0336	36	21.5	34	3145	835
180-0436	42	21.5	34	3145	835

180-0336 has pullout on left

180-0436 has pullout on right

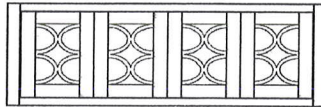

ITEM #	W	D	H	A	Stone Top/Sink
180-0542	42	21.5	34	3645	N/A
180-0548	48	21.5	34	3745	1065
180-0560	60	21.5	34	3845	N/A

Pullouts on both sides

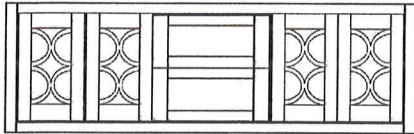

ITEM #	W	D	H	A	Stone Top/Sink
180-0760	60	21.5	34	3945	1730
180-0766	66	21.5	34	4045	N/A
180-0772	72	21.5	34	4145	N/A

2 Drawers in the center

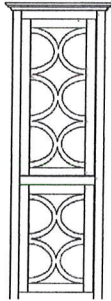

**Stephen Wall Hung Linen Tower**

\*Measurements are without crown molding

Includes 3 adjustable shelves in upper section

Hinge Left or Hinge Right

Includes 2 adjustable shelves in lower section

Hamper Option - \$250.00

ITEM #	W	D	H	A
180-0924L	*22	*15	78	3345
180-0924R	*22	*15	78	3345

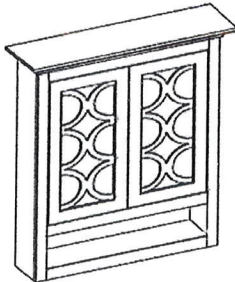

**Stephen OTJ Cabinet**

\*Measurements are without crown molding

Includes 2 adjustable wood shelves

ITEM #	W	D	H	A
280-2724	*24	*8.5	32	1495
280-2730	*30	*8.5	32	1595

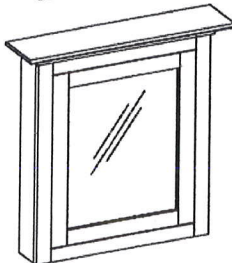

**Signature Medicine Cabinets**

\*Measurements are without crown molding

Mirrored Back panel in cabinet

Includes 3 adjustable glass shelves

Mirrored Door Front

Hinge Left or Hinge Right

Surface Mount	W	D	H	A
200-2516 L/R	*16	*4.75	32	1195
200-2520 L/R	*20	*4.75	32	1295
200-2524 L/R	*24	*4.75	32	1395

Recessed	W	D	H	A
200-2616 L/R	*16	*4.75	32	1195
200-2620 L/R	*20	*4.75	32	1295
200-2624 L/R	*24	*4.75	32	1395

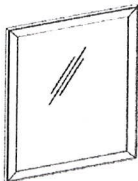

**Face Frame Mirror**

ITEM #	W	D	H	A
200-2016	18.5	.75	33.25	525
200-2020	22.5	.75	33.25	535
200-2024	26.5	.75	33.25	545

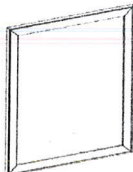

**Face Frame Medicine Cabinet Surround**

ITEM #	W	D	H	Roborn Size	A
200-2116	18.5	.75	33.25	16 x 30	475
200-2120	22.5	.75	33.25	20 x 30	489
200-2124	26.5	.75	33.25	24 x 30	495